

# Stainless Steel Check Valves

## 200 CWP • Y-Pattern • Threaded Cap

Figure 49  
Threaded Ends

**Size Range:**

½ through 2 inches

**Design Features:**

- Integral Seat
- Y Pattern

**Pressure Temperature Ratings:**

- 200 psi @ -20°F to 100°F
- 135 psi @ 500°F Max

**Industry Standards**

Pipe Threads	ASME B1.20.1
--------------	--------------

**Materials of Construction**

1	Body	ASTM A351 CF8M
2	Cap	ASTM A351 CF8M
3	Disc	ASTM A351 CF8M
4	Hinge Arm	ASTM A351 CF8M
5	Hinge Pin	316 SS
6	Disc Nut	316 SS
7	Disc Washer	316 SS
8	Plug	316 SS
9	Seal	PTFE
10	Gasket	PTFE

**Dimensions and Weights**

Valve Size	Weight (lbs)	Dimensions (inches)	
		A	B
½	0.7	2.56	1.8
¾	1.1	3.15	2.0
1	1.5	3.54	2.4
1 ½	3.1	4.72	3.2
2	4.6	5.51	3.7

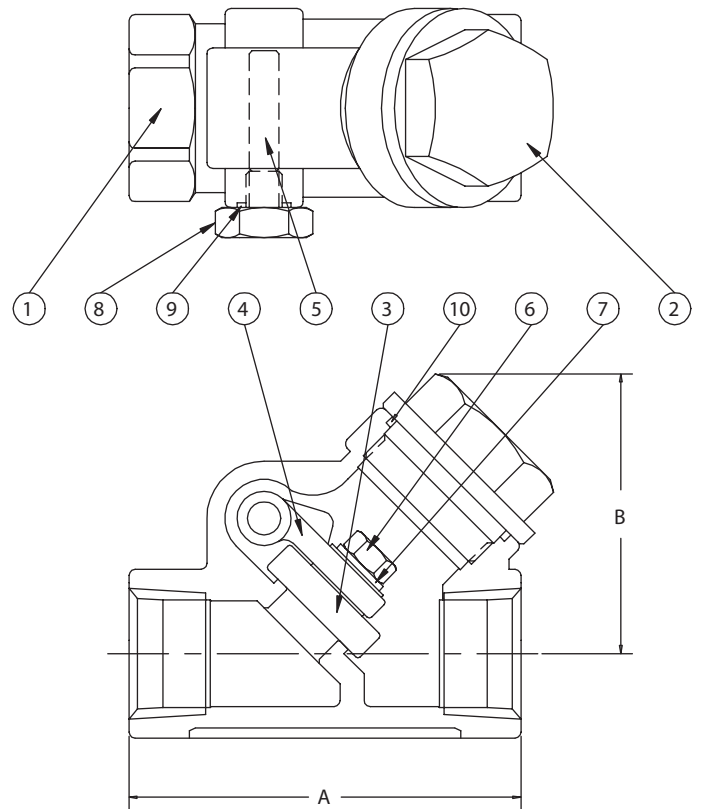

Fig. 49